

# WINTON COMPACT FLAIL MOWER

## WCF SERIES



**OWNERS MANUAL**

**PLEASE READ THIS MANUAL BEFORE OPERATING THE MOWER**

Congratulations on purchasing your new **Winton** mower!

Before you get started, we have provided a helpful space to jot down a few important details about your new Winton machine.

Model Number: **WCF**

Serial Number:

Date of purchase:

Factory Reference: EF85/EF105

This manual should be considered a permanent part of this machine and should remain with it even if the machine is subsequently sold.

Winton continually seeks advancements in its product design and quality. Therefore, while this manual contains the most current product information available at the time of printing, there may be minor discrepancies between your machine and this manual.

If you have any questions concerning this manual, please consult your local dealer.

## **General Safety Information**

Ensure all potential operators read this manual thoroughly before using the machine.

**Safety:** Ensure tractor and machine is stopped & keys out of ignition before set-up/maintenance.

**Safety:** Failure to follow good safety standards could result in severe injury or even death.

**Misuse:** This machine is designed for use with compact tractors, and should be used only for the indicated purpose. Winton does not take responsibility if the machine is used for any other purpose. Children must not operate the machine under any circumstance.

**Modification:** Do not modify equipment in any way. This may impair the operation and overall safety of the machine.

**Tractor requirements:** Use only with compact tractors within power range specified.

**Misuse transport:** Do not use machinery to transport personnel or livestock.

**Condition:** For the safety of personnel and optimum performance of the machine, you should check the condition of the machine and the tractor before starting. Before use check all nuts and bolts are tight.

**Spatial awareness:** Always check the operating area is safe before starting machinery.

**Operator clothing:** The operator should not wear loose clothing while operating machinery.

**Safety wear:** Always use appropriate ear protection when running a tractor and machinery. Ensure you are wearing protective gloves when servicing and using machinery.

**Bystander safety:** Ensure bystanders keep away from the machine when it is in use. Do not touch moving parts when the machine is at work.

**Public places:** When travelling on the road/public places, always keep the PTO turned off.

**Maintenance:** Always keep the machine maintained and in a good state. Where necessary, repair or replace any defective parts. Do not modify the machine.

**Sharp objects:** Pay attention to the sharp/pointed parts while servicing the machine.

**Safety guards:** All protective parts should be in good condition before operating machinery.

**Safety signs/stickers:** Keep all safety signs clean and legible. Replace any which are missing or illegible. If a component with safety sign/(s) is replaced, make sure new safety sign/(s) are attached in the same locations.

**Operating speeds:** Machinery and PTO should be operated at the recommended speed at all times.

**Safety awareness:** Good safety requires that you familiarise yourself with various safety signs, the type of warning and the area, or particular function related to that area.

**Alertness:** Never consume alcohol or drugs these can hinder alertness/coordination. Consult your doctor about using this machine while taking prescription medications.

## **General Safety Information (continued)**

### **Machinery Pre-Use Checks**

On receipt of your new Winton machine and again within the first 4 hours of use, or the 'shake in' period as we like to call it, we always recommend checking over the machine.

- Check all bolts, nuts and screws are tight on the unit.
- Tighten/check any bolts and nuts securing blades.
- If your machine has belts check the tension and adjust if required.
- Apply grease to grease points if necessary.
- Check gear oil level and top up if needed. Do not overfill.

### **Tractor Pre-Use Checks**

Check that the machine is properly attached to the tractor. Ensure that secure pins are used on the linkage mounting pins.

Be sure to add extra weights to the front of the tractor or add wheel weights if required.

Check that the tractor PTO shaft turns freely and that the machines PTO drive shaft can extend easily. Grease the PTO drive shaft using the grease points.

The chain on the PTO shaft should be checked and in a good condition. The universal joints installed should be in a good state, with proper protective parts.

Before installing the PTO shaft, the tractor and machine should be stopped and remove the key.

Install and secure all safety guards, doors and covers before starting.

Bystanders should leave the immediate area before connecting the drive from the tractor.

### **Running/Operating Checks**

- Always keep the PTO output from the tractor at **540 RPM** when running machinery.

### **Post-Use Regular Checks**



Check blades, belts and wearing parts. Be sure they are not damaged and blades swing freely in their mount. Repair or replace as required.

Clean machinery and check for/clear any entangled material which may have got stuck around any rotating parts.

## Contents

	Pg.
General Safety information	1-2
1. Dimensions and Specifications	3
2. Installation & Set Up	4
3. Cutting Height Adjustment	5
4. Gear Oil Change & Check	6
5. Adjusting Belt Tension	7
6. Parts Diagram	8
7. Parts List	9
8. Servicing & Maintenance	10
PTO Shaft Resizing	11
Winton Product Warranty	12
Trouble Shooting	13

### 1. Dimensions & Specifications

Model	WCF85	WCF105
Weight	100kg	130kg
Working Width	80cm	103cm
PTO Turning Speed	540 RPM	540 RPM
Hammer Flail Type		
Number Of Flails	12	18
Recommended Tractor HP	12-20 hp	15-25 hp
Width	100cm	118cm
Depth	70cm	70cm
Height	70cm	70cm
PTO Shaft Size	80cm	80cm
Cutting Height	3-8cm	3-8cm
Linkage Size	Category 1	Category 1
Number Of Belts	3	3

## **2. INSTALLATION & SET UP**

**Safety:** Ensure tractor and machine is stopped & keys out of ignition before set-up/maintenance.

**Safety:** Before attaching/detaching machinery ensure the hydraulic lift system is in a neutral position.

**Safety:** Make sure the PTO drive isn't connected at any point until instructed to do so.

### You will need:

Your tractor, tractor top link arm (adjustable), linkage pins, PTO shaft & some elbow grease!

### Attaching The Mower

Start by finding a flat piece of ground. Lower the three point linkage on your tractor to its lowest position and attach the mower to the tractor using the three point linkage pins and linch pins.

With the rear roller on the mower on the ground, adjust the length of the top link arm so that the skids at the side of the flail mower are parallel with the ground.

Then by hand rotate the blade rotor by hand so that a row of blades hang vertically towards the ground to give an idea of the cutting height. Check the clearance between the bottom of the blades and the ground, this should be at least 50mm.

The cutting height can be set for longer grass by simply raising the hydraulic lift arms on your tractor or/and by adjusting the rear roller and skids on the machine to increase or decrease the blade clearance as required [see section on adjusting the cutting height].

The working speed of the machine should always be at a walking pace (approx. 2 to 5 mph) depending on the working conditions. Overgrown grass and weeds should be cut at a much slower pace for the best cut and to avoid any damage to the mower.

Check your PTO shaft's grease points and apply grease if needed. Then attach the PTO drive shaft and ensure the locking pin is secure on both the tractor and mower sides. Attach the chain to a secure point on the tractor/implement.

Operate the flail mower the with tractor in low range gear and the PTO delivering 540 RPM.

### Pre-Mowing Checklist

Before starting the machine, always check and adjust the following:

- Set correct cutting height. [Section 3]
- Oil level of the gearbox. [Section 4]
- Tension of the drive belt [Section 5]
- Lubrication/grease points. [Section 8]
- Tightness of all bolts, nuts and screws.
- All protective guards are in place before operating.

### **3. CUTTING HEIGHT ADJUSTMENT**

**Safety:** Ensure tractor and machine is stopped & keys out of ignition before set-up/maintenance.

**Note:** Clearance of blades to the ground should be at least 50mm and higher on uneven ground.

Getting the cutting height right is the key to creating the best cut and finish when mowing. This needs to be adjusted depending on the lay of the land and also the length of grass and density of weeds.

The cutting height can be set for longer grass by simply raising the hydraulic lift arms on your tractor or/and by adjusting the rear roller and skids on the machine.

#### **Roller Adjustment**

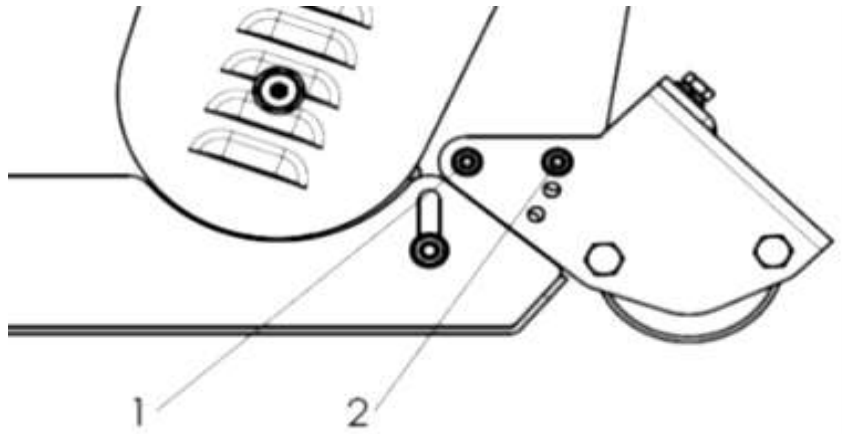

1. Loosen bolt **1** and remove bolt **2** on both sides of the machine.
2. Adjust roller by aligning the selected hole in the roller support bracket at position **2** (using the hole closest to the ground gives the highest working height).
3. Put bolt **2** into the selected hole and re-tighten bolts **1** and bolts **2**.

#### **Skid Adjustment**

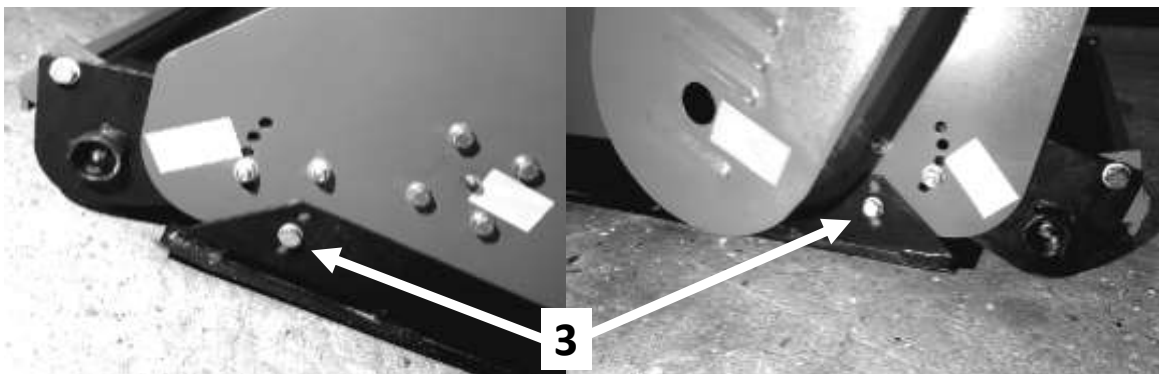

1. Loosen bolts **3** on the skids on the front & back of both sides of the machine.
2. Move the skids up or down to the desired height.
3. Re-tighten bolts **3**.

#### **4. GEAR OIL CHANGE & CHECK**

**Safety:** Ensure tractor and machine is stopped & keys out of ignition before set-up/maintenance.

##### **Important Information**

Gear Oil Grade	80w90 gear oil for all conditions (or equivalent)
Gearbox Oil Level	Approx. 0.5 litres to half full
Drive Reservoir Oil Level	Approx. 0.2 litres to level plug
First Oil Change	50 hours use
Oil Change Frequency	250 hours/yearly (whichever is first)

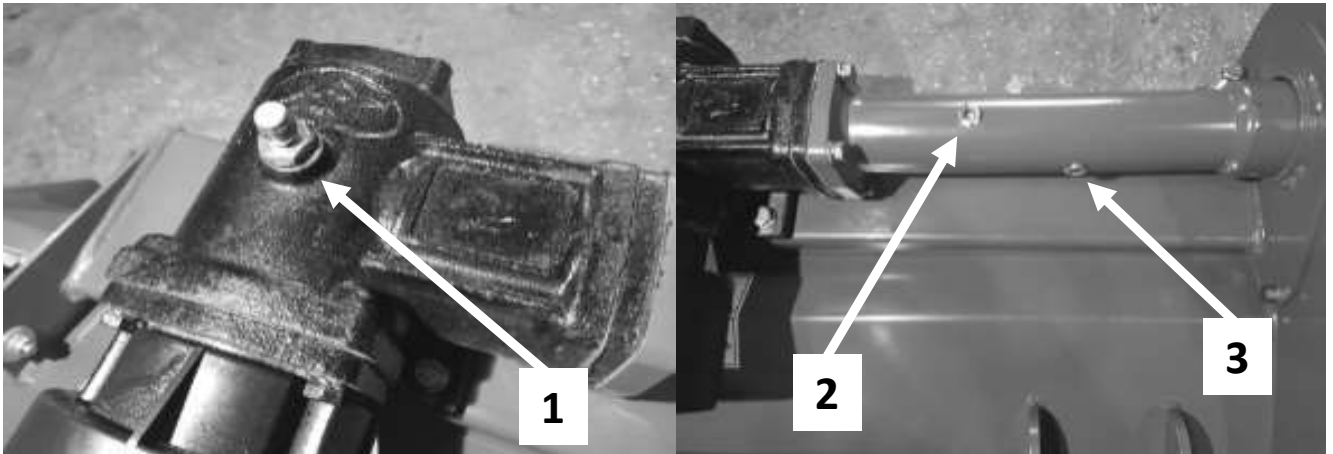

##### **Oil Change/Check Gearbox**

1. Remove filler plug **1**.
2. Use an oil pump to extract all of the oil/debris from the gearbox.
3. Check oil using a ruler (gearbox should be half full). Top up if required and replace plug **1**.

##### **Oil Change/Check Drive Reservoir**

1. Unscrew plugs **2** and **3**.
2. Use an oil pump to extract all of the oil/debris.
3. Fill with new gear oil to the level plug **2**.
4. Replace plugs **2** and **3**.

##### **Oil Change Log**

Oil Change #1	Oil Change #2	Oil Change #3	Oil Change #4	Oil Change #5	Oil Change #6
/ /	/ /	/ /	/ /	/ /	/ /



## **5. ADJUSTING BELT TENSION**

**Safety:** Ensure tractor and machine is stopped & keys out of ignition before set-up/maintenance.

### **Correct Belt Tension**

The correct belt tension is achieved when the belt can be deflected by the belt thickness about 10mm at the centre point between the pulleys.

A generic measure across machines is the belt should be able to twist a quarter turn by hand. Any more and they are too loose and any less and too tight, you may run the risk of losing drive to the mower or burning the belts out prematurely.

Always use a straight edge to make sure the belt pulleys are in line and running true. If misaligned, call your dealer or service engineer for technical support.

### **Belt Tensioning**

1. Remove the belt cover.
2. Loosen the bolts **A** and **B** that lock the support shaft.
3. Loosen off counter nut **C**.
4. Loosen bolts **D** securing the gear box to the mounting plate.
5. Adjust belt tension by adjusting the height of counter nut **C**.
6. Align the gearbox ensuring the drive shaft is parallel with the body and re-tighten nuts **D**.
7. Tighten bolts **A** and **B**.
8. Replace the belt cover.

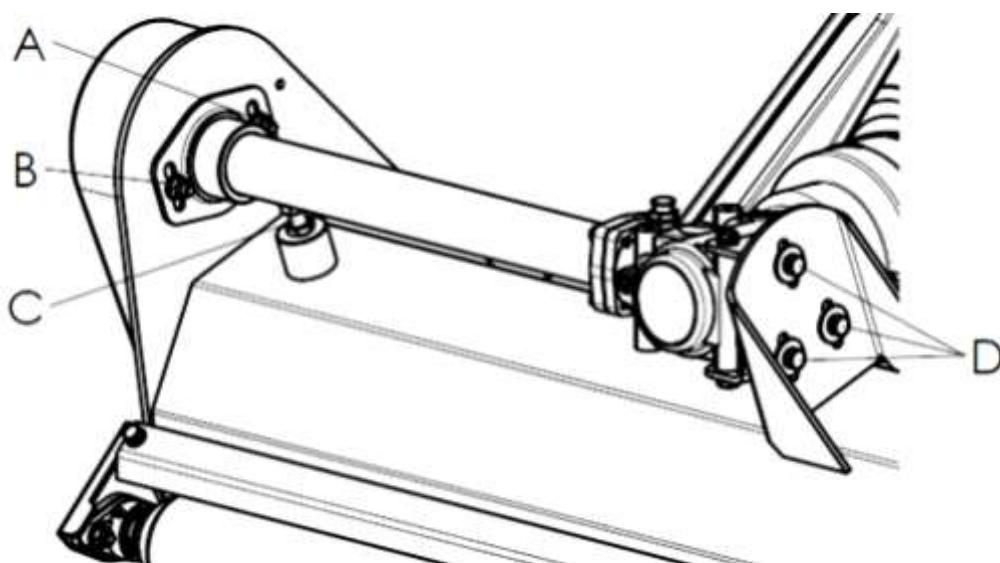

## 6. PARTS DIAGRAM

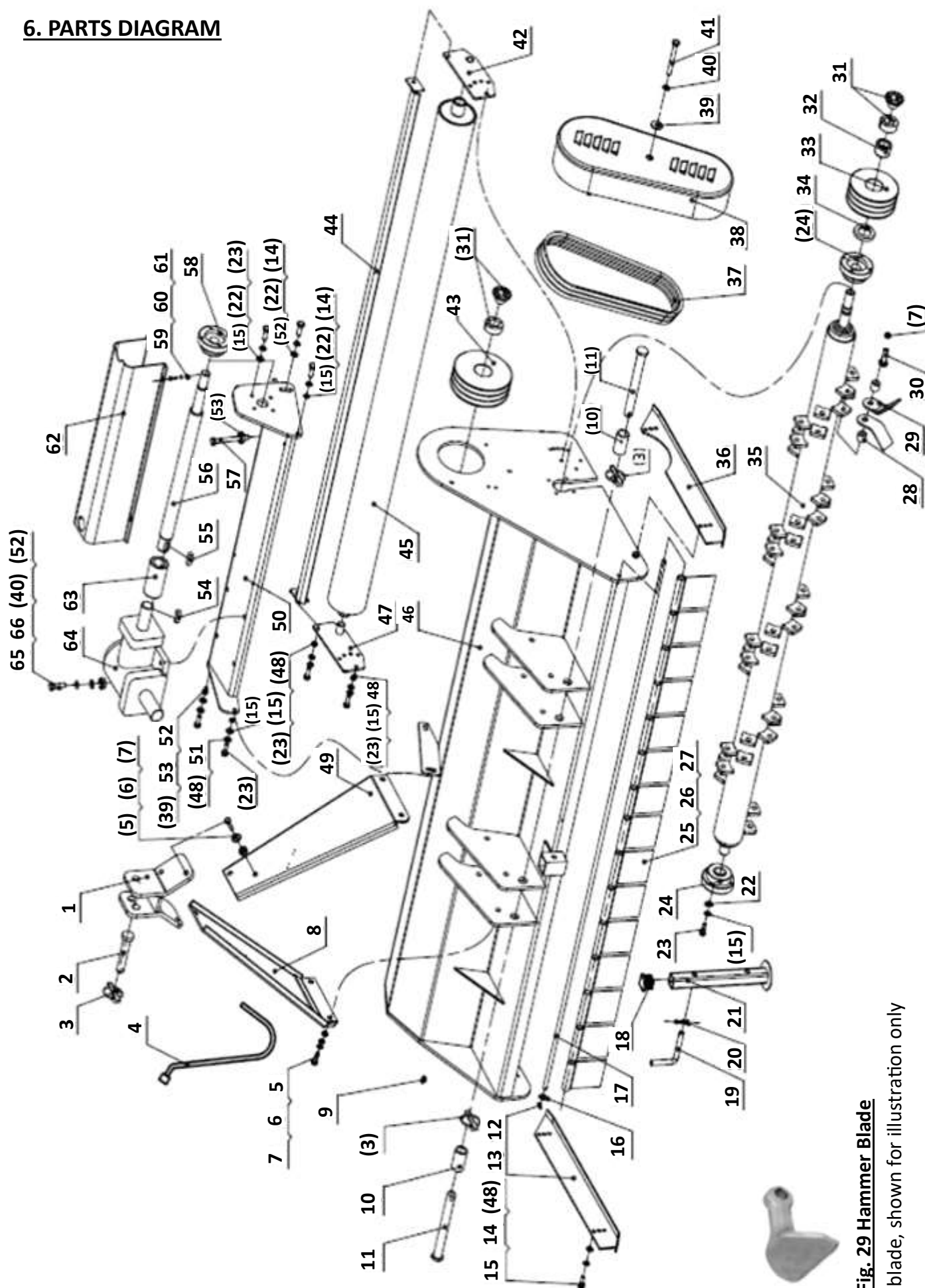

**Note: Fig. 29 Hammer Blade**

not 'Y' blade, shown for illustration only

## 7. PARTS LIST

Ser.No.	Part No.	Name & Specification	Quantity
1	EF175-020	Hanging arm weldment	1
2	EF175-118	Hanging pin (upper)	1
3	MT001	Pin shaft weldment	3
4	EF175-117	Hook weldment	1
5	GB5783-86	Bolt M12*35	8
6	GB6170-86	Plain washer 12	16
7	GB6184-86	Locknut M12	8
8	EF175-022	Connection arm weldment(R)	1
9	DIN71412-86	Oil cup M8*1	1
10	EF175-114	Sleeve	2
11	EF175-120	Hanging pin (down)	2
12	GB879-86	Slotted spring pin 4	2
13	EFL155-021	Connection plate assembly	1
14	GB5783-86	Bolt M8*20	6
15	GB97.1-86	Plain washer 8	40
16		Plain washer 10*1	30
17	EFL155-110	Fender axle	1
18	EF175-115	Square pipe stopper	1
19	EF175-116	Right angle pin	1
20	GB91-86	Cotter pin	1
21	EF175-023	Supporting foot weldment	1
22	GB93-87	Spring washer Φ8*1.5	15
23	GB5783-86	Hex bolt M8*25	19
24		UC205 Bearing seat assembly	2
25	EF175-108	Fender(General)	17
26	EF175-109	Fender(Allocated)	3
27	EF175-108(A)	Fender(General)	3
28	EFL155-102	Distance sleeve	48
29	EFL155-113	Y blade	48
30	GB5782-86	Bolt M12*80	24
31		Swellable sleeve 22X47X34	2
32	EFL155-103	Bushing block	1
33	EFL155-109	Driven wheel (Vice)	1
34	GB13871-86	Oil seal 55*40*8	1
35	EFL155-014	Blade axle weldment	1
36	EFL155-020	Connection plate assembly	1
37	GB11544-86	Strap 13*940	3
38	EFL155-022	Belt wheel cover weldment	1
39	GB96.1	Big plain washer 10	2
40	GB93-86	Spring washer 10	5
41	GB5782-86	Bolt M10*95	1
42	EFL155-016	Adjustable welding assembly(L)	1
43	EFL155-108	Driven wheel (Main)	1
44	EFL155-018	Fender welding assembly	1
45	EF175-013	Roller assembly	1
46	EFL155-011	Welding bracket assembly	1
47	EFL155-017	Adjustable welding assembly(R)	1
48	GB6184-86	Locknut M8	11
49	EF175-021	Left connection arm weldment	1
50	EFL155-012	Gear box support assembly	1
51		Middle plain washer 8	2
52	GB6170-86	Nut M8	5
53	GB5783-86	Bolt M10*35	1
54	GB1095-86	Flat key 10*10*35	1
55	GB1095-86	Flat key 10*10*20	1
56	EFL155-106	Coupling shaft	1
57	GB2783-86	Bolt M10*70	1
58		UC205 Bearing seat assembly	1
59	GB29.2-2000	Six angle cross bolt M8*20	4
60	GB97.1-2000	Plain washer 8	4
61	GB93-2000	Spring washer 8	4
62	EFL155-104	Gear box protection cover	1
63	EFL155-107	Axle sleeve	1
64	XH30.290Z.01W	Gear box	1
65	GB5783-86	Hex bolt M10*40	4
66	GB97.1-86	Plain washer 10	10

## **8. SERVICING & MAINTENANCE**

**Safety:** Store all lubricants away from excessive heat, dust, moisture and contaminants.

**Safety:** Ensure tractor and machine is stopped & keys out of ignition before set-up/maintenance.

Grease Type	Multi-purpose lithium based grease
Grease Frequency	Check every 4-8 hours (top up if required)

### **Greasing & Lubrication Points**

1. Bearings on the blade rotor x2
2. Bearings on the rear roller x2
3. PTO shaft x2

Wipe grease nipples with a clean cloth before greasing to avoid injecting any dirt and grit. Press grease into each grease nipple three to five times. We recommend using a hand-held grease gun for best results.

If grease nipples will not take grease, remove and clean thoroughly. Also clean lubricant passageway. If you notice any grease points are broken replace or repair them immediately.

### **Other Maintenance**

**Blades:** Check condition of the blades and replace if worn/broken. Always take care when handling blades, wear gloves and use suitable tools for changing blades. If blades are replaced check they are balanced in order to avoid any excessive vibration.

**Belts:** Check the condition of belts, if worn or frayed replace. Adjust the belt tension if required.

**Oils:** Ensure oil levels are checked and topped up when needed. Replace any oils per the schedule.

**PTO Shaft:** Check the condition of your PTO shaft and replace if worn or damaged immediately.

**Cleaning:** Ensure the mower deck is cleaned of mud and grass. Remove debris from any moving parts to prevent entanglement. Do not spray water on bearings when cleaning with a high pressure washer.

**Bearings:** Check the bearings on the blade rotor and the rear roller. If the oil seals are damaged debris may enter the bearings. Clean and replace with new bearings if necessary. Run the mower without a load for 3-5 minutes to check bearings are operating smoothly.

**Paintwork:** Re-coat any damaged paintwork to prevent corrosion.

**Storage:** Store the machine in a dry, level area. Support the frame if necessary.

**Skids:** Check the condition of the side skids and replace if worn.

\*The periods recommended are based on normal operating conditions. Severe or unusual conditions may require more frequent maintenance.

## PTO SHAFT RESIZING

**Safety:** Ensure tractor & machine is stopped & keys out of ignition before carrying out any work. If you are not confident in carrying out the work consult your local supplier or mechanic.

Most PTO driven implements are supplied with a standard sized PTO shaft. As all tractors vary this often means cutting it down to size. Always replace worn or damaged PTO shafts.

Attach the machine to the tractor without the PTO shaft, raise the linkage so the PTO shaft is level/horizontal. Measure the length between tractor PTO and the machine's shaft. If the compressed (closed) PTO shaft length exceeds the one measured here then the driveline will need to be cut.

1. PTO length adjustment, first remove PTO shaft shielding.



2. Shorten the driveline tubes to proper equal lengths.



3. Tidy edges of the drive tube with a file and clean all fillings from the tubes.



4. Shorten the equally long guard tubes to the same length as the driveline tubes.



5. Grease the internal driveline tube.

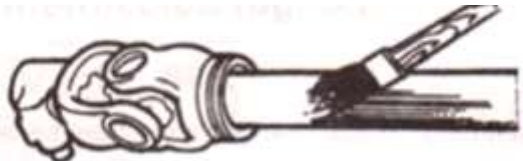

6. Fit the guard on the shaft.

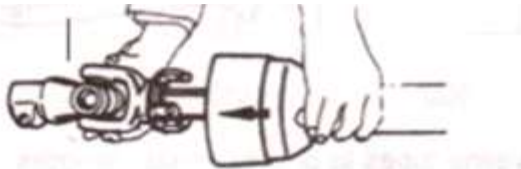

7. Make sure that the length allows for at least 16cm (6 inches) of overlap.



## WINTON PRODUCT WARRANTY

We always strive to create great products, but when something does go wrong we have a strong network of resellers on hand throughout the UK to help out.

### Warranty Claims

Before you get in touch here are 5 pieces of information your Winton reseller will need to progress your claim:

- Your invoice/order details - to include date of purchase
- Machine model number
- Machine serial number
- Details of the fault
- Images/videos of the fault

### The Terms & Conditions

All products purchased as new are covered under our 12 month warranty from the date of purchase. During this period Winton will repair or replace defective parts free of charge. This warranty is given on the proviso that the product has been used and maintained according to the Owner's Manual.

Warranty is carried out on a return to reseller / manufacturer basis and excludes any labour or delivery / collection costs.

### Exclusions

- Wearing parts are excluded; including but not limited to blades, belts and bearings.
- Modification of the product in any way will cease the manufacturers warranty.
- The machine is warranted for one year to the original purchaser, resale within the period will cease the warranty.
- Damage in transit is not covered. Claims will need to be made through the courier or your Winton reseller directly.
- Compensation for down-time, labour or loss of earnings is not covered by the warranty.
- No warranty extension will be granted for replacement parts fitted.
- Damage caused by continued use of a faulty machine will not be covered.

Your **Winton** reseller will provide their own terms and conditions upon purchase, consult this for any additional queries.

## **TROUBLE SHOOTING**

**Safety:** Ensure tractor and machine is stopped & keys out of ignition before set-up/maintenance.

<b>WCF Problem</b>	<b>Solution</b>
Belt Slipping	Clean the mower deck. Adjust the belt tension. Replace belts.
Patches of uncut grass	Mow at 540 PTO rpm, check PTO speed & tractor power output. Change into a lower gear on the tractor. Tighten belts. Replace any missing/damaged blades.
Excessive vibration	Replace blades. Replace belts. Align/replace belt pulleys. Remove belt guard and clean debris from belt area. Check PTO shaft for damage and replace.
Gearbox noisy	Check oil level and top up if required. Extract the oil/debris and replace with new oil.
Blades scalping	Raise cutting height. Change mowing pattern/route. Reduce speed when turning.
Uneven cut	Change into a lower gear on the tractor. Level the mower using tractor linkage. Replace any missing/damaged blades.
Tractor loaded down by mower	Mow at 540 PTO rpm. Change into a lower gear on the tractor. Clean off the mower. Check power output on your tractor.

Always consult your **Winton** dealer if you have any questions about your machine.



[www.wintonmachinery.co.uk](http://www.wintonmachinery.co.uk)